

Alvey Estate (Sedan Road) Revised Scheme Option

Contents

Slides 3-4	Overview
Slide 5	Plan showing estate
Slide 6	First scheme consultation
Slide 7	New scheme location
Slide 8	New scheme – How it could look
Slide 9	Number of possible new homes
Slide 10	The benefits of the new scheme
Slide 11	Next Steps

Overview

Site identified for redevelopment as an infill site on the Alvey Estate. In February 2020 we consulted with the local community and your Tenants and Residents Association on building 10 new homes. Residents asked us to look at other options that could provide homes for those in need on the estate.

Overview cont...

A revised scheme has been suggested by using the land on the play area, creating a better connection to an existing row of flats and re-locating and providing a new play area to a more visible and accessible area on Sedan Way, with no loss of amenity provision.

Plan showing estate



First scheme consulted on

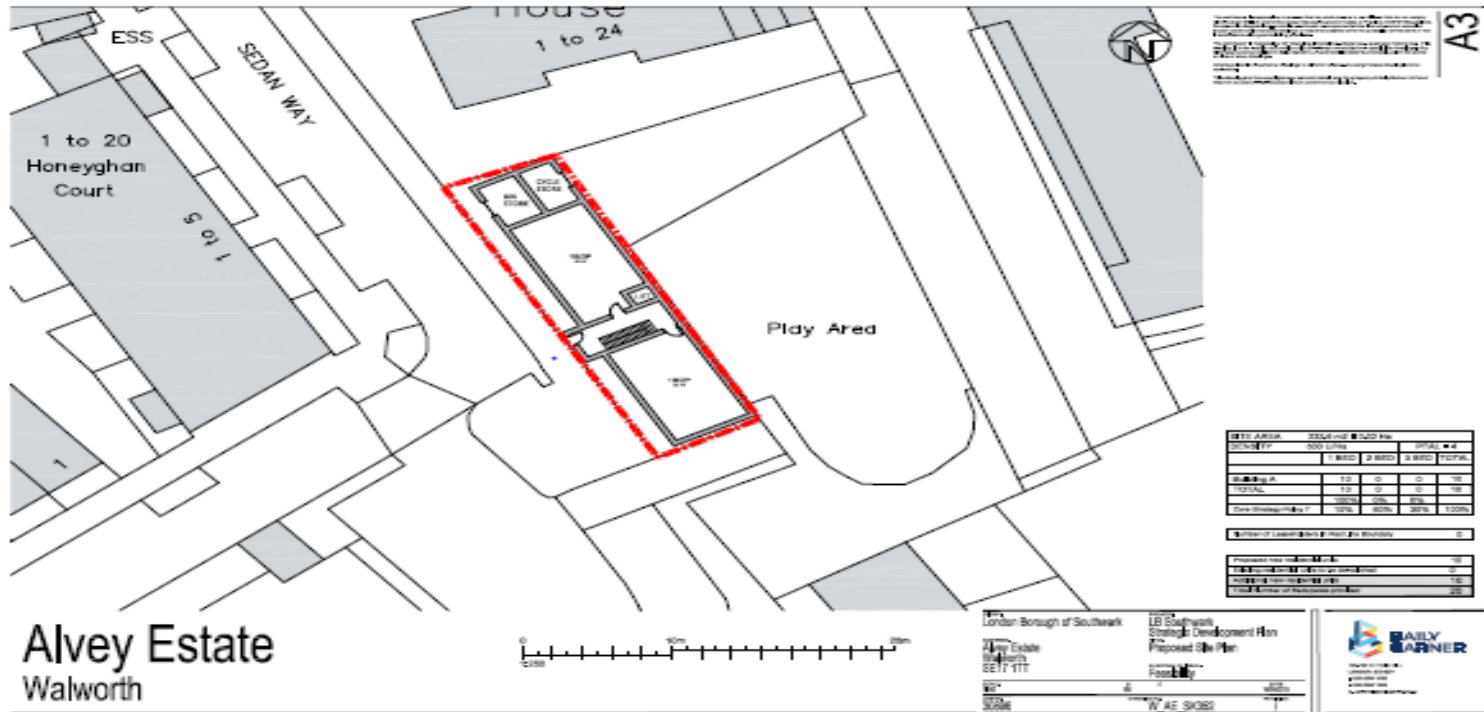

New scheme location

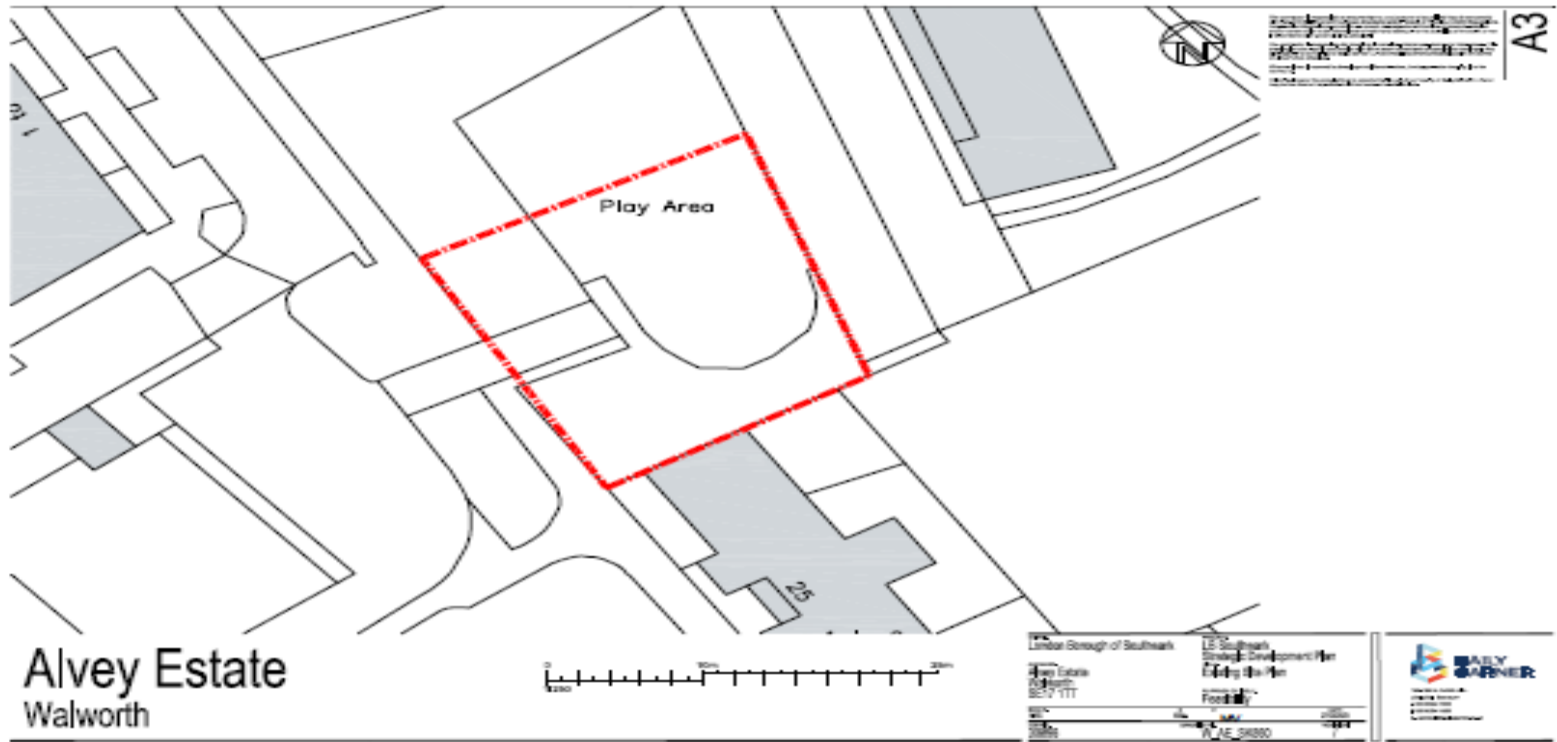

New scheme – how it could look



Number of possible new homes

SITE AREA	578.8 m ² = 0.05 Ha			
DENSITY	300 U/Ha		PTAL = 4	
	1B/2P	3B/5P	4B/6P	TOTAL
Building A (5 storeys)	5	6	4	15
TOTAL	5	6	4	15
	30.3%	40%	29.7%	
No. of Bedspaces	10	30	24	64

The benefits of the new scheme

- Delivers new homes to contribute to council targets
- 15 quality affordable homes including large family accommodation
- Houses 64 people
- Uses disused land areas
- Provides new and improved play area and landscaping

Next Steps

- To hear your views on this alternative scheme
- Feedback to you regarding the outcome of this consultation
- Feedback to your Tenants & Residents Association and Ward Cllrs