

- Notes:**
1. Dimensions in meters, unless otherwise stated.
 2. No topographical survey had been done; in order to accurately place or locate elements on site.

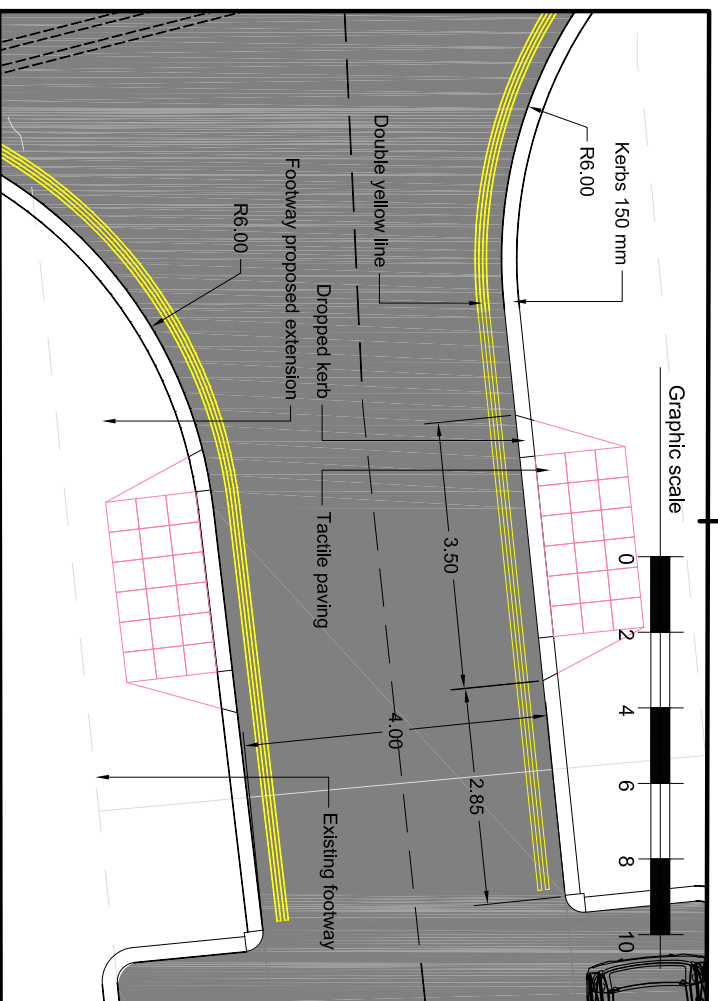

Dropped kerb at junctions - 1:100

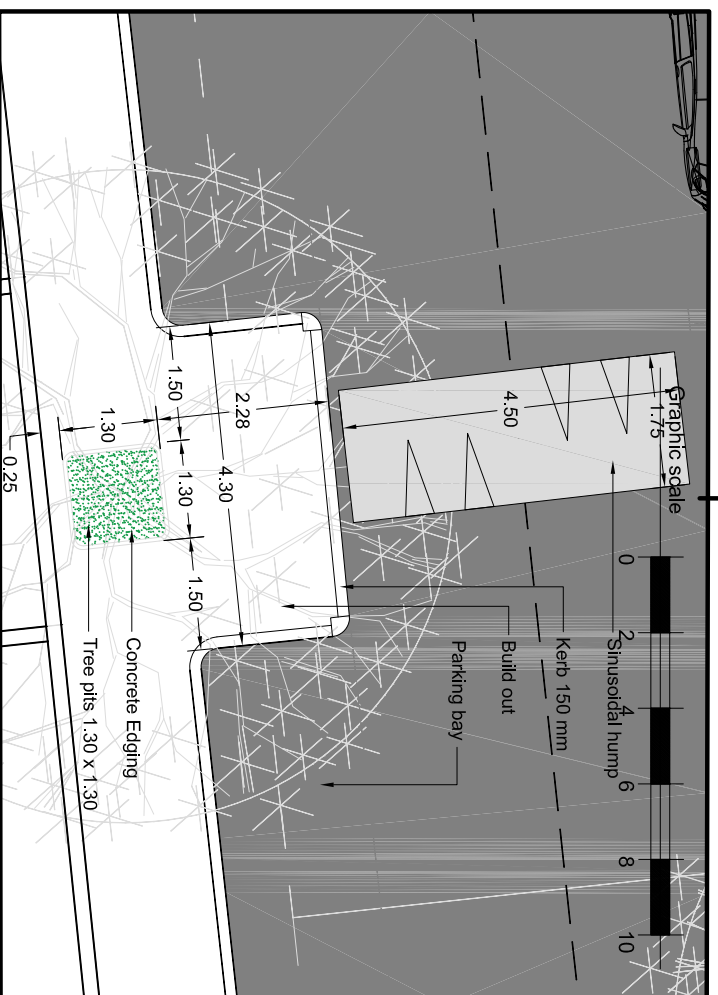

Build outs around existing trees - 1:100

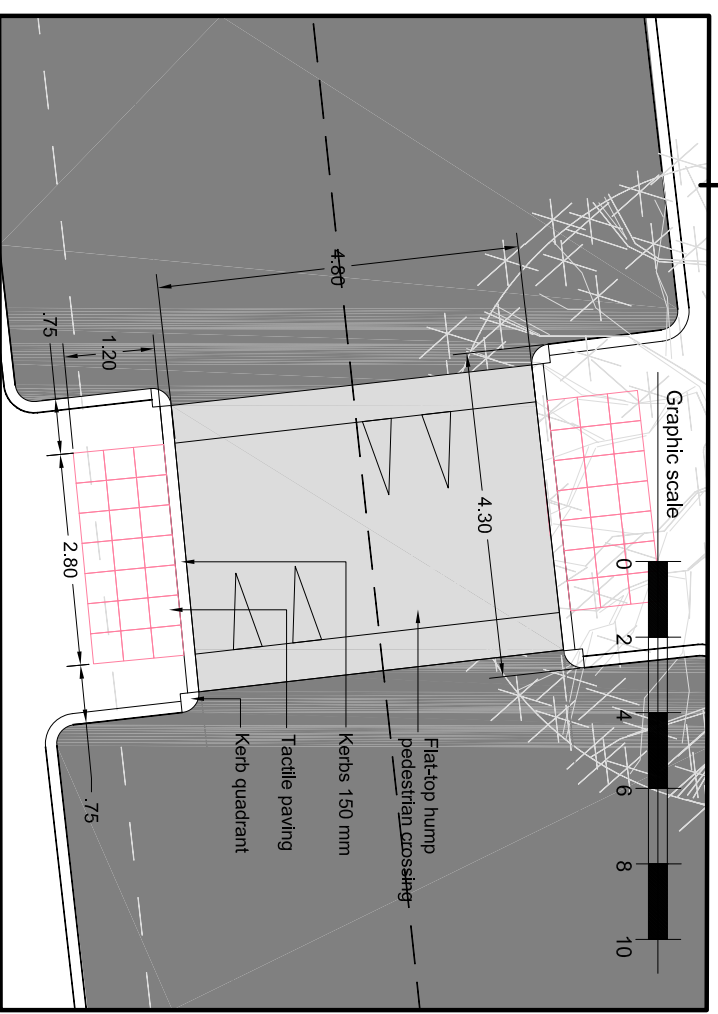

Flat top humps - 1:100

Rev	Date	Description	Drm	Chk	App
R1	25/8/17	Scheme extension over Br Park	IG	AS	RW
R2	30/8/17	Build outs modification	IG	AS	RW
R3	11/9/17	Scheme ext. Dropped kerbs	IG	AS	RW

Project
**North Camberwell
 improvements**

Drawing Title

**Sector 1
 Benhill road improvements**

Community council
Southwark

Ward(s)
Camberwell

Date	Scale	Drm	Rev	App
Sept '17	As Indicated	IG	AS	RW

Drawing number

NC2



**Highways Division
 Transport projects
 Minor Works**

Environment and Social
 Regeneration
 Floor 3, Hub 2
 160 Tooley Street
 PO Box 64529
 London SE1P 5LX