

LOCATION PLAN

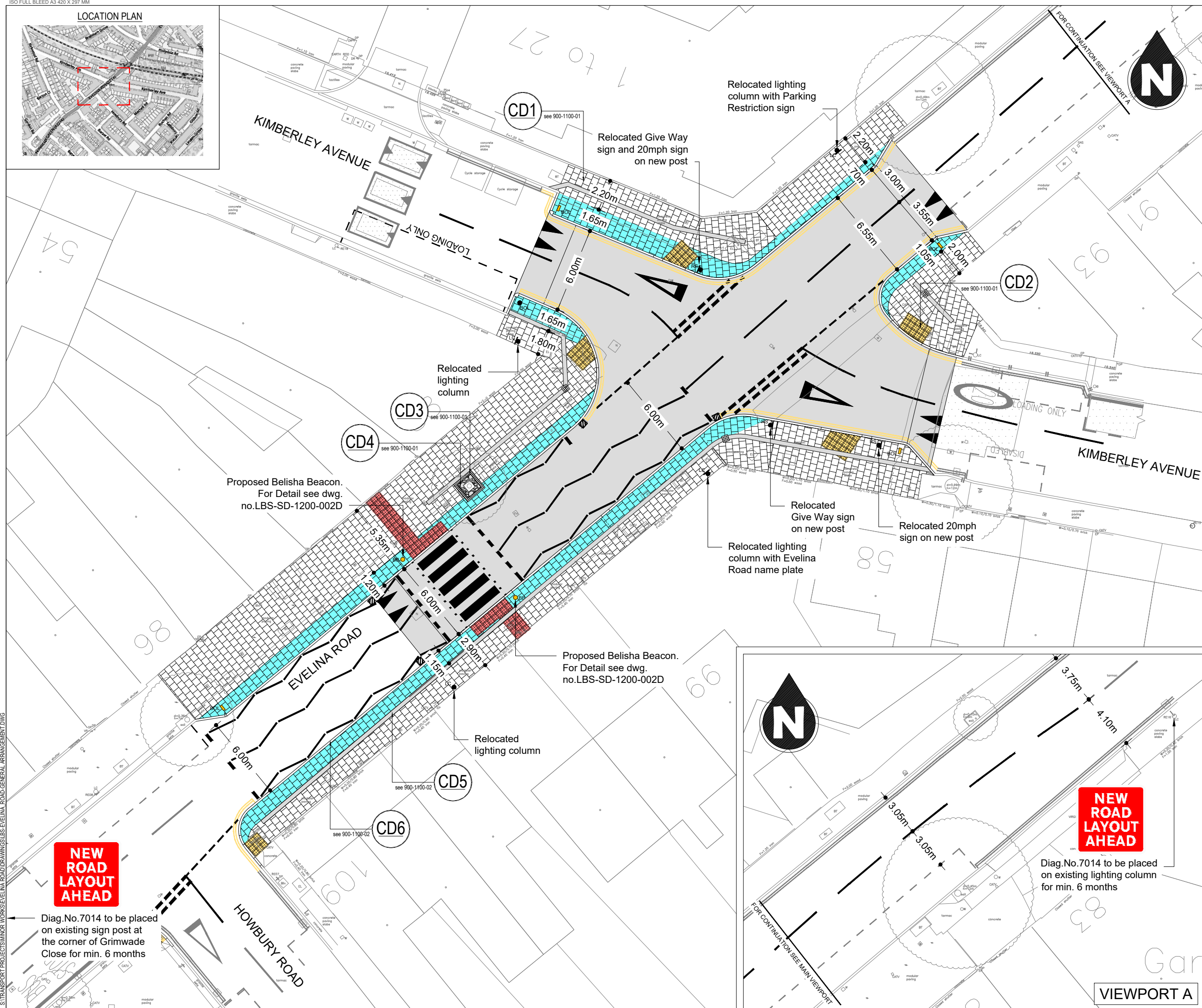
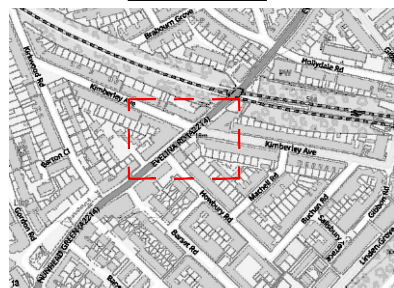

- NOTES**
- Dimensions in meters, unless otherwise stated.
 - This drawing should be read in conjunction with other relevant engineering details, drawings & specifications.
 - Any discrepancies should be reported to the design engineer immediately, so that clarification can be sought prior to the commencement of works.
 - The dimensions must be verified on site before construction.
 - All works are to be in accordance with Southwark borough council specification and standards.

- KEY**
- F-B1-PC(70)**
Pre-cast concrete flag on existing footway, pimple finish, grey, 600x600x70. Area: 390m². For Detail see CD1 on dwg. no.LBS/MW/EVELINA_RD/900-1100-01
 - F-B1-PC(63)**
Pre-cast concrete flag on new buildout, pimple finish, grey, 600x600x63. Area: 138m². For Detail see CD1 on dwg. no.LBS/MW/EVELINA_RD/900-1100-01
 - TREE PIT**
Bark mulch with 80x80x80 granite block surround at tree pit locations. Area: Bark Mulch - 2m² / Granite blocks - 2m². For Detail see CD3/CD4 on dwg. no.LBS/MW/EVELINA_RD/900-1100-01
 - T(B)-PC(65)**
Blister tactile stone slab, buff/red as shown, 400x400x65. Area: Buff - 13m² / Red - 13m². For Detail see CD4/CD5 on drawing no.LBS/MW/EVELINA_RD/900-1100-01
 - 150x300mm GRANITE KERB**
Proposed and re-laid granite kerb, 150x300mm. (130m relaid / 22m new). For Detail see CD2 on drawing no.LBS/MW/EVELINA_RD/900-1100-01
 - 300mm ASP laid as channel**
300 mm wide artificial stone paving laid as channel. Area: 100m². For Detail see CD6 on drawing no.LBS/MW/EVELINA_RD/900-1100-02
 - GRANITE QUADRANT KERB**
300mm radius granite quadrant kerb on build-out. Quantity: 5no.
 - PROPOSED ROAD MARKING**
Proposed/Refreshed road markings
 - PROPOSED MANCHESTER BOLLARD**
Manchester bollard with reflective banding and Keep Right/Left sign plate. Quantity: 1no.
 - PROPOSED KEEP RIGHT BOLLARD**
Retro-reflective bollards with Keep Right sign face. Quantity: 4no.
 - PROPOSED CARRIAGEWAY GULLY**
Cycle friendly Chute Gully (4no.). For Detail see DD2 on drawing no.LBS/MW/EVELINA_RD/500-02
 - PROPOSED FOOTWAY GULLY**
Cycle friendly Chute Gully (3no.). For Detail see DD2 on drawing no.LBS/MW/EVELINA_RD/500-02
 - RELOCATED SIGN ON NEW POST**
Relocated Give Way/20mph sign on new post. Quantity: 4no.
 - RELOCATED LIGHTING COLUMN**
Relocated Give Way/20mph sign on new post. Quantity: 4no.
 - EXTENT OF NEW RAISED TABLE**
Raised table junction. Area: 475m²

REV	DATE	REVISION DESCRIPTION / DETAILS	DRN BY	CHKD BY	APPRD BY
A	22.09.23	OUTLINE DESIGN	BR	--	--



PROJECT:
MINOR WORKS
EVELINA ROAD/KIMBERLEY AVENUE
IMPROVED CROSSING ARRANGEMENTS

TITLE:
GENERAL ARRANGEMENT

STATUS:	OD	DRAWN	BR
SCALE:	1:250 @ A3	DESIGNED	BR
DRAWING NO:	LBS/MW/EVELINA_RD/GA-01	CHECKED	--
DATE DRAWN:	22 SEPT 2023	APPROVED	--
DATE ISSUED:	XXX	REV:	A

NEW ROAD LAYOUT AHEAD

NEW ROAD LAYOUT AHEAD

Diag.No.7014 to be placed on existing sign post at the corner of Grimwade Close for min. 6 months

Diag.No.7014 to be placed on existing lighting column for min. 6 months

VIEWPORT A