

A young girl with long dark hair, wearing a black t-shirt and patterned pants, is in the foreground, looking up and reaching out with her hands as if to catch a red frisbee. The frisbee is suspended in the air above her. In the background, a boy in a striped shirt is seen from behind, also looking towards the frisbee. The setting is a park with wooden play structures and greenery.

# Brunswick Park Play Space

*'Concept to Outline Design'*

# Davies White Landscape Architects

“It is our mission to create **inspiring** play spaces that will please, **excite**, **challenge** and **satisfy** children and adults alike.

This requires **knowledge** and **experience** of play, technical skills, construction skills, an understanding of children and, above all a **creative imagination.**”

***Davies White Ltd***

# Scope of Works...

# Scope of Works...

## The scope of the consultation and design work

- Davies White will design a NEW play space to replace the existing playground
- It will be a bespoke design
- Use some natural elements
- Provide a wide range of play experiences
- Be accessible and inclusive
- Encourage Cross Generational Play
- Provide risk and challenges
- Be sustainable and easy to maintenance
- Include low grassy mounds & playful planting
- Include a boundary fence and gates
- Protect the existing trees
- Make sure the design is approved signed off by a Play Safety Inspector



# Brunswick Park – May 2016



# Brunswick Park- Existing Park and Playground



Aerial View and 3D  
View of Brunswick Park  
May 2016





# Brunswick Park- Existing Park and Playground



The Before Photographs – April 2016



# Brunswick Park- Existing Park and Playground



The Before Photographs – April 2016



# Engagement ...

# Brunswick Park- Meeting Stakeholder Officers



Concept Design review with Southwark Council Officers

# Brunswick Park- Community Engagement Day

**EVENT:** Community Drop In Event

**WHERE:** Brunswick Park Playground

**DATE:** Friday the 10<sup>th</sup> June 2016

**TIME:** 2.30pm until 5.30pm

Come along and meet the council officers and landscape architects involved in the Brunswick Park Play Space Regeneration project.

Have input into the design and view the concept ideas and scale model.





# Circulation & Boundary ...

# Circulation and project area

*Existing Playground Boundary.*

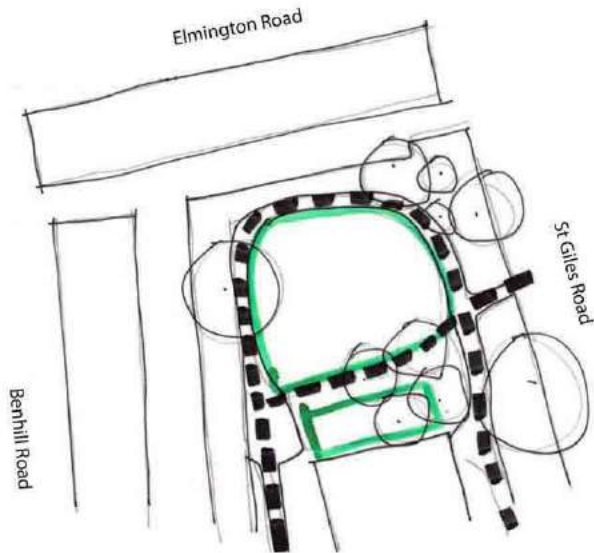

*Proposed Playground Boundary.*

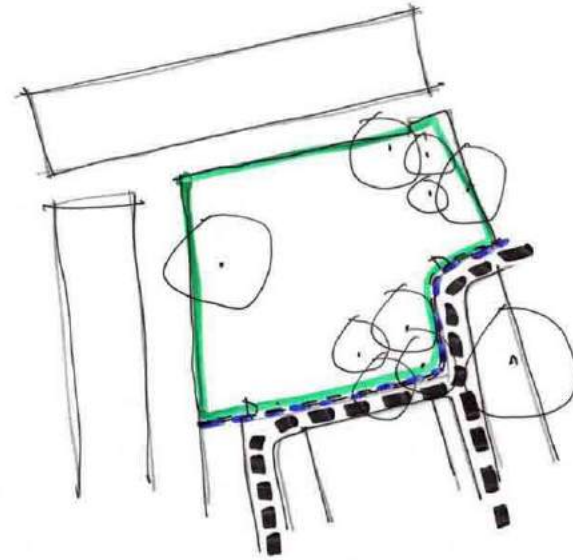

*Key benefits.*

- 1. Maximises space for play.*
- 2. Maintains circulation through park.*

# Circulation and project area



Existing Playground



Design Layout - Zone Plan



# Concept & Inspiration ...

# Brunswick Park Play Project – Concept Idea Board

## Concept

Today's children and families often have limited opportunities to connect with the natural environment. Modern family life has changed dramatically in the last two decades. Some children spend more time watching television and playing video games on computers than they do being physically active outside and their health and wellbeing are being negatively affected.

In the past decade, the benefits of connecting to nature have been well documented in numerous research studies and publications\*. Collectively, this body of research shows that children's social, psychological, academic and physical health is positively impacted when they have daily contact with nature.

Making a naturalised outdoor multisensory play environment can go some way to encouraging a reconnection with nature, these environments stimulate a diversity of play experiences and contribute to a child's healthy development.

## Community + Place.

Brunswick Park is a local park at the heart of the community. This is an opportunity to develop a multi-sensory play environment that meets the needs of local people. A fun and challenging place for all ages that becomes a great place to meet friends and family. It is important that the new play space becomes part of the life of local people and families and their input into the design and development process will maximise this potential.

## The existing playground.

The existing playground is old and does not offer an imaginative range of play activities. It is ready for an upgrade. The existing equipment will be removed including the fence and hedge, this will enlarge the playground and allow more space for a better range of activities and the opportunity to create a playful garden feeling to the space. The new space will be zoned for a range of ages but also into places for active and challenging play and other places for more quiet activities and meeting up with friends. A new fence will be installed to maintain the play space as dog free.

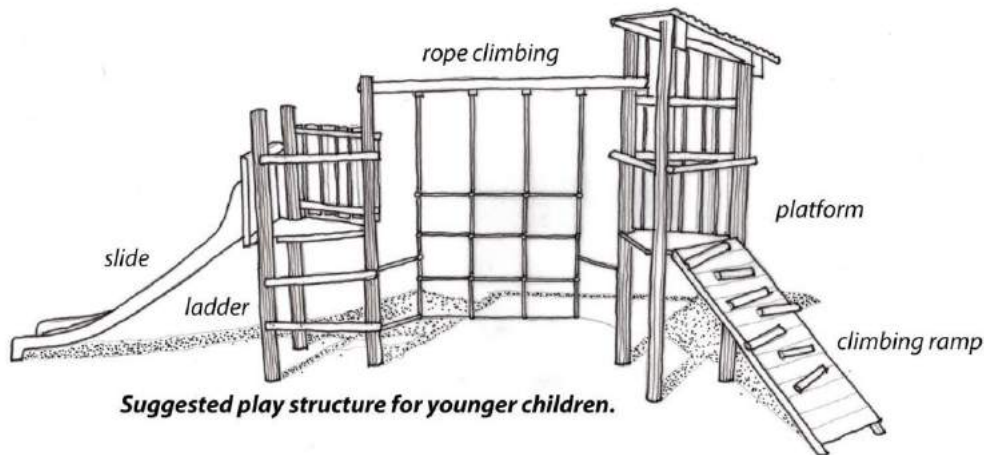

## Meeting places + social space.

As well as a range of play activities a good playspace needs places to meet with friends. It also needs places to enjoy the outdoors throw a ball around or simply sit out and enjoy the fresh air. The new playspace will include different types of seats, with backrests and without. Some benches to lie back and enjoy the sun and some picnic table and seats if you want to spend the day in the park.

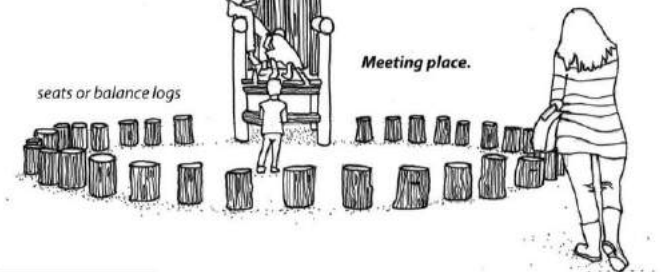

## Nature + Wildlife.

An important part of the playspace will be new trees and planting. This will bring another dimension to the space with textural variety, scent and seasonal change. This will also be a place to encourage wildlife, with nectar rich plants for insects and ground cover planting to attract birds. In places new grass areas can be left to grow long or mown into paths or a maze pattern. Seasonal variety means that on each visit the playspace has something new to see and it helps to create a welcoming place where everyone will want to spend time and enjoy the outdoors.





# Brunswick Park Play Project – Concept Idea Board



## Play for older children.

Older children often like to challenge themselves physically. For this reason it is good to have some high structures with several sorts of climbing activities, ropes, walls, poles etc. They also like to measure their ability with their friends, so it is good to have large structures where lots of children can be together. Swings are always a favourite and basket swings especially good where a team can get the swing going really high.



## Play for toddlers and younger children.

Younger children and toddlers also like to test their ability and challenge themselves physically, but they can be equally happy with very small scale objects that are interesting because they have a distinctive texture or make an interesting sound. Although play space are for all ages making a place specially for younger children means they do not get overwhelmed by the more active play usually associated with older children.

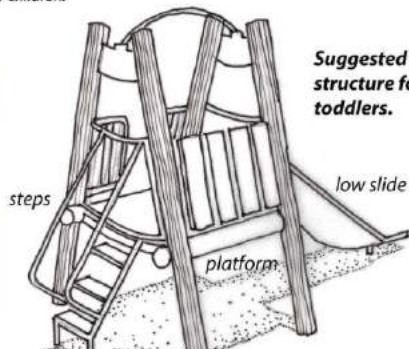

**Suggested play structure for toddlers.**

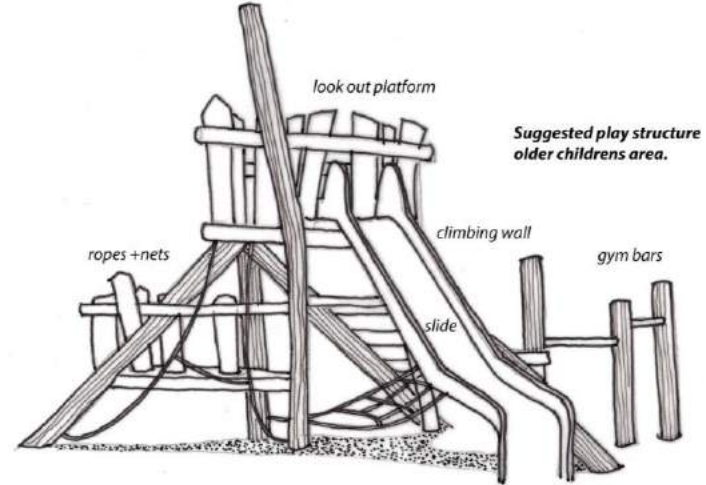

**Suggested play structure older childrens area.**

## Play activities.

The best play space are welcoming to everyone whatever their ability or age. So a range of physical activities are included as well as other restful and relaxing spaces. Swinging and sliding are always favourite activities, along with climbing, balancing, rocking, bouncing and gliding. Places to get up high or down low and underneath all add to the range of playful activities, and make the play space a multisensory environment.



## Materials.

A range of materials will be used in the playspace with some timber play structures as well as some metal. Surfaces will include natural grass, plus impact absorbing play surfaces like rubber and artificial grass as well as some stone and rock. Colours will be kept natural looking with wood, stone and plants, this helps to create an atmosphere of calm and relaxation.





# Brunswick Park Play Project – Concept Idea Board

## Concept

Today's children and families often have limited opportunities to connect with the natural environment. Modern family life has changed dramatically in the last few decades. Some children spend more time watching television and playing video games on computers than they do being physically active outside and their health and wellbeing are being negatively affected.

In the past decade, the benefits of connecting to nature have been well documented in numerous research studies and publications\*. Collectively this body of research shows that children's social, psychological, academic and physical health is positively impacted when they have daily contact with nature.

Making a naturalised outdoor multi-sensory play environment can go some way to encouraging a reconnection with nature. These environments stimulate a diversity of play experiences and contribute to a child's healthy development.

## Community + Place.

Brunswick Park is a local park at the heart of the community. This is an opportunity to develop a multi-sensory play environment that meets the needs of local people. A fun and challenging place for all ages that becomes a great place to meet friends and family. It is important that the new play space becomes part of the life of local people and families and their input into the design and development process will maximise this potential.

## The existing playground.

The existing playground is old and does not offer an imaginative range of play activities. It is ready for an upgrade. The existing equipment will be removed including the fence and hedge, this will enlarge the playground and allow more space for a better range of activities and the opportunity to create a playful garden feeling to the space. The new space will be zoned for a range of ages but also into places for active and challenging play and other places for more quiet activities and meeting up with friends. A new fence will be installed to maintain the play space as dog free.

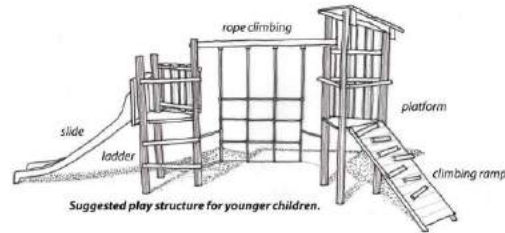

## Meeting places + social space.

- As well as a range of play activities a good playspace needs places to meet with friends.
- It also needs places to enjoy the outdoors through a ball around or simply sit out and enjoy the fresh air.
- The new playspace will include different types of seats, with backrests and without. Some benches to lie back and enjoy the sun and some picnic table and seats if you want to spend the day in the park.

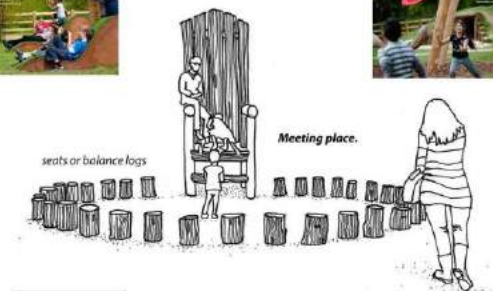

davieswhite  
landscape architects  
davieswhite.co.uk



## Play for older children.

- Older children often like to challenge themselves physically.
- Good to have some high structures with several sorts of climbing activities.
- Older children also like to measure their ability with their friends, so it is good to have large structures for groups.
- Basket swings are especially good where lots of children can play together.



## Play for toddlers and younger children.

- Younger children and toddlers also like to test their ability and challenge themselves physically.
- They can be equally happy with very small scale objects that are interesting because they have a distinctive texture or make an interesting sound.
- Younger children also need their own space where they do not get overwhelmed by the more active play usually associated with older children.

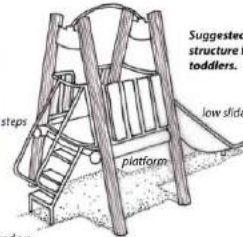

## Woodland play garden.

- A space for quieter activities and in hot weather will be a cool and shady space for sitting and resting.
- Small play activities will be included for example balance logs, sound tubes, and space to picnic.
- The area will be grassed with some low level planting.
- The focus here will be on colour texture and sound, along with a variety of plant colours, scents and textures.



## Play activities.

- The best play space are welcoming to everyone whatever their ability or age.
- A range of physical activities are included as well as other useful and relaxing spaces.
- Swinging and sliding are always favourite activities, along with climbing, balancing, rocking, bouncing and gliding.
- Places to get up high or down low and underneath all add to the range of playful activities, and make the play space a multisensory environment.



## Materials.

- A range of materials will be used in the playspace with some timber play structures as well as some metal.
- Surfaces will include natural grass, plus impact absorbing play surfaces like rubber and artificial grass as well as some stone and rock.
- Colours will be kept natural looking with wood, stone and plants, this helps to create an atmosphere of calm.



## Nature + Wildlife.

- New trees and planting will bring another dimension to the space with textural variety, scent and seasonal change.
- This will encourage wildlife, with nectar rich plants for insects and ground cover planting to attract birds.
- In places new grass areas can be left to grow long or mown into paths or a maze pattern.
- Seasonal variety means that on each visit the playspace has something new to see and it helps to create a welcoming place where everyone will want to spend time and enjoy the outdoors.



Brunswick Park Camberwell. Play regeneration project. Concept ideas.

davieswhite  
landscape architects  
davieswhite.co.uk

# Concept to Outline Design...



Brunswick Park Play Space Concept Design Drawing – April 2016



## Brunswick Park Play Space - Concept Design Development



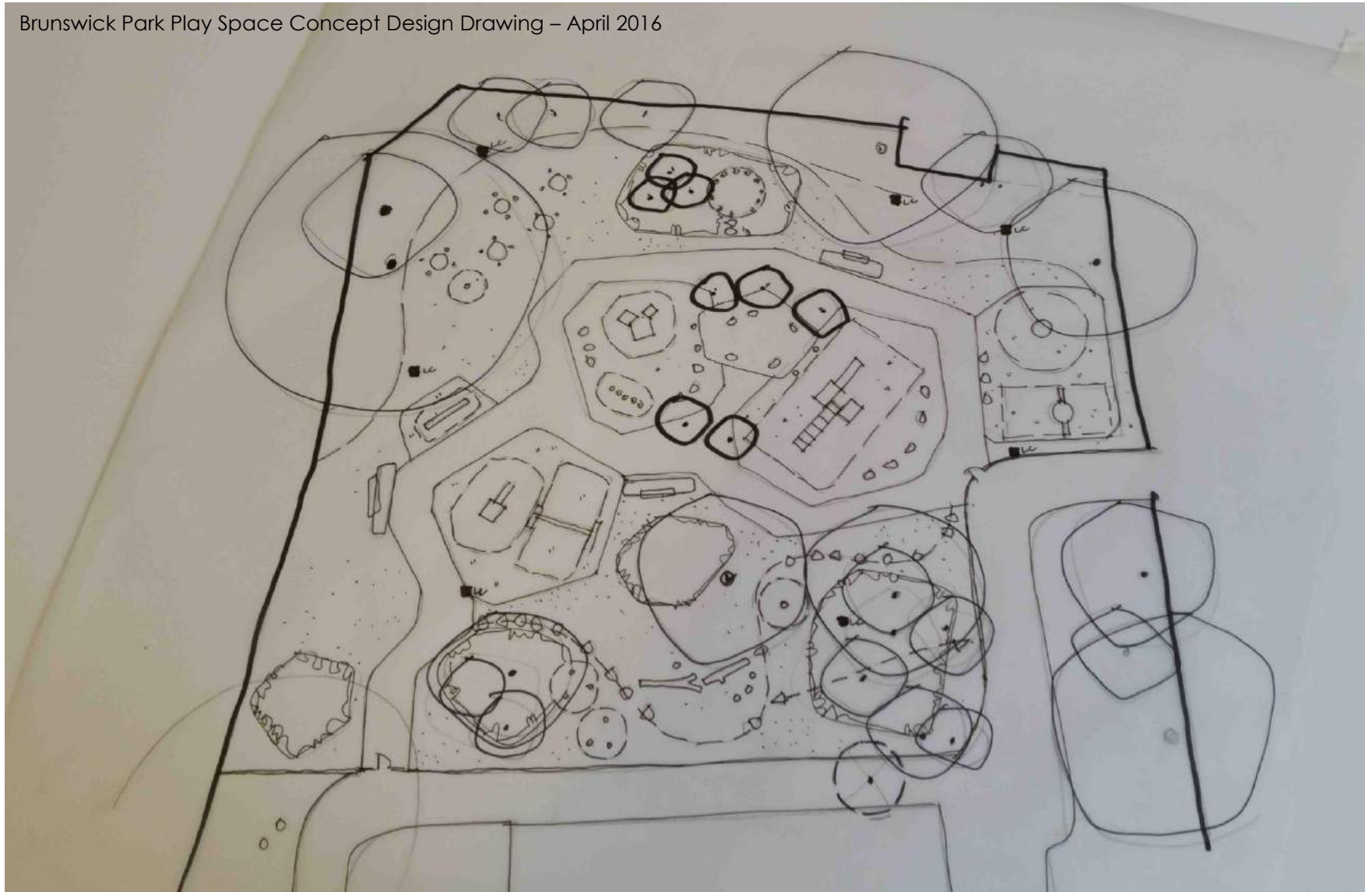

## Brunswick Park Play Space – Outline Design Development

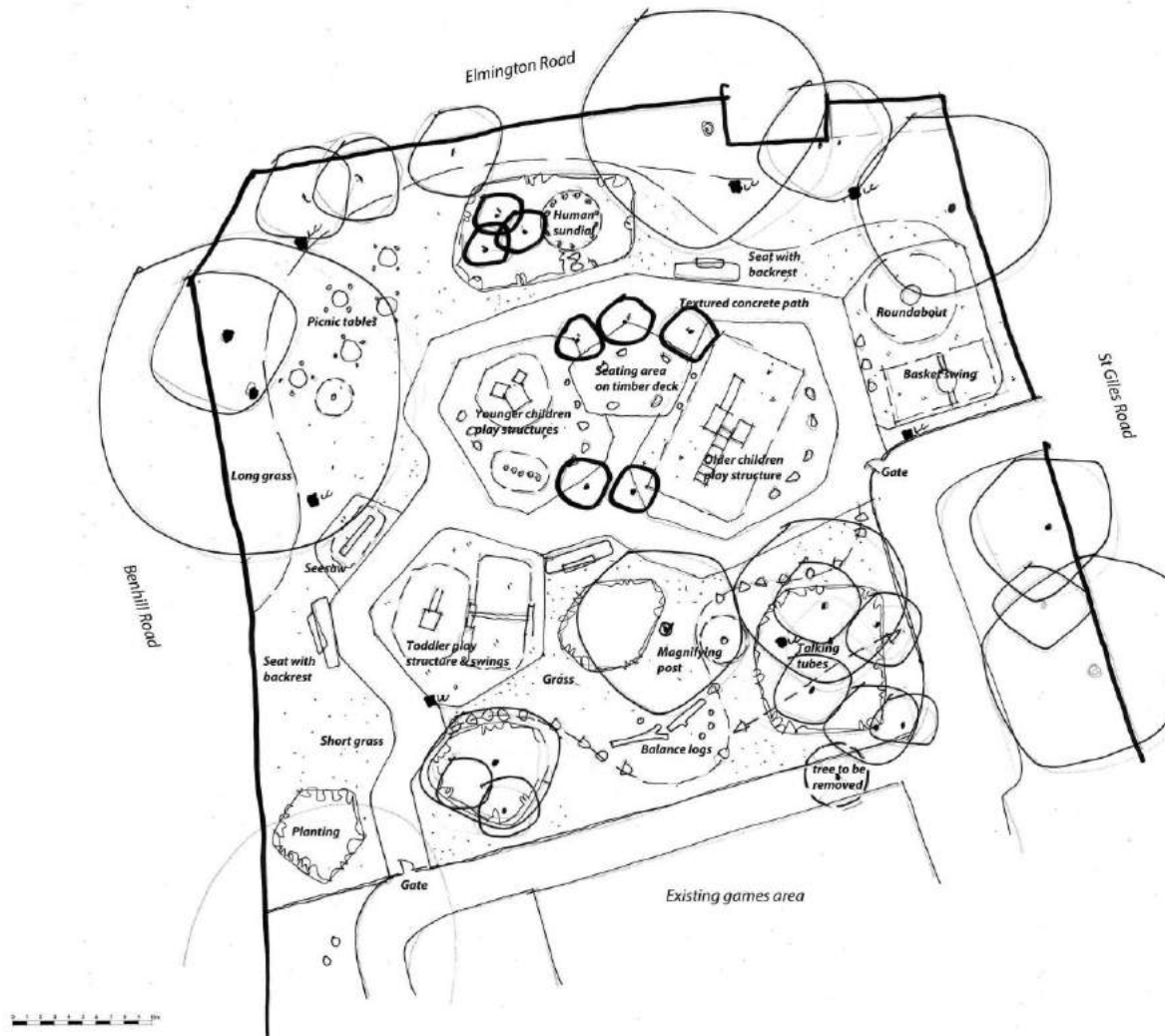

## Brunswick Park Play Space – Outline Design Development

# Brunswick Park Play Space.

Designs for 3  
different play  
structures.

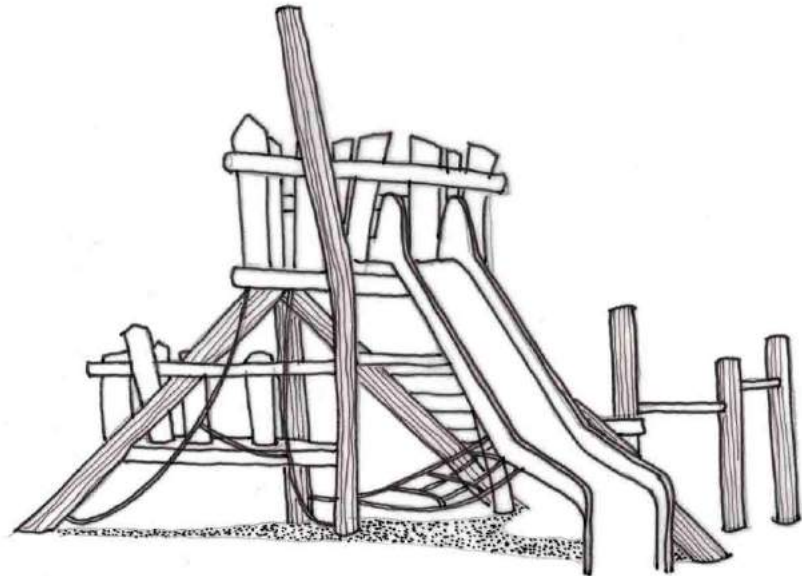



# Outline Sketch Design Model ...

Brunswick Park, London  
**Play Space Proposals**  
Concept Model - Scale 1:200

**davieswhite**  
landscape architects  
[davieswhite.co.uk](http://davieswhite.co.uk)

1:200 Scale Model

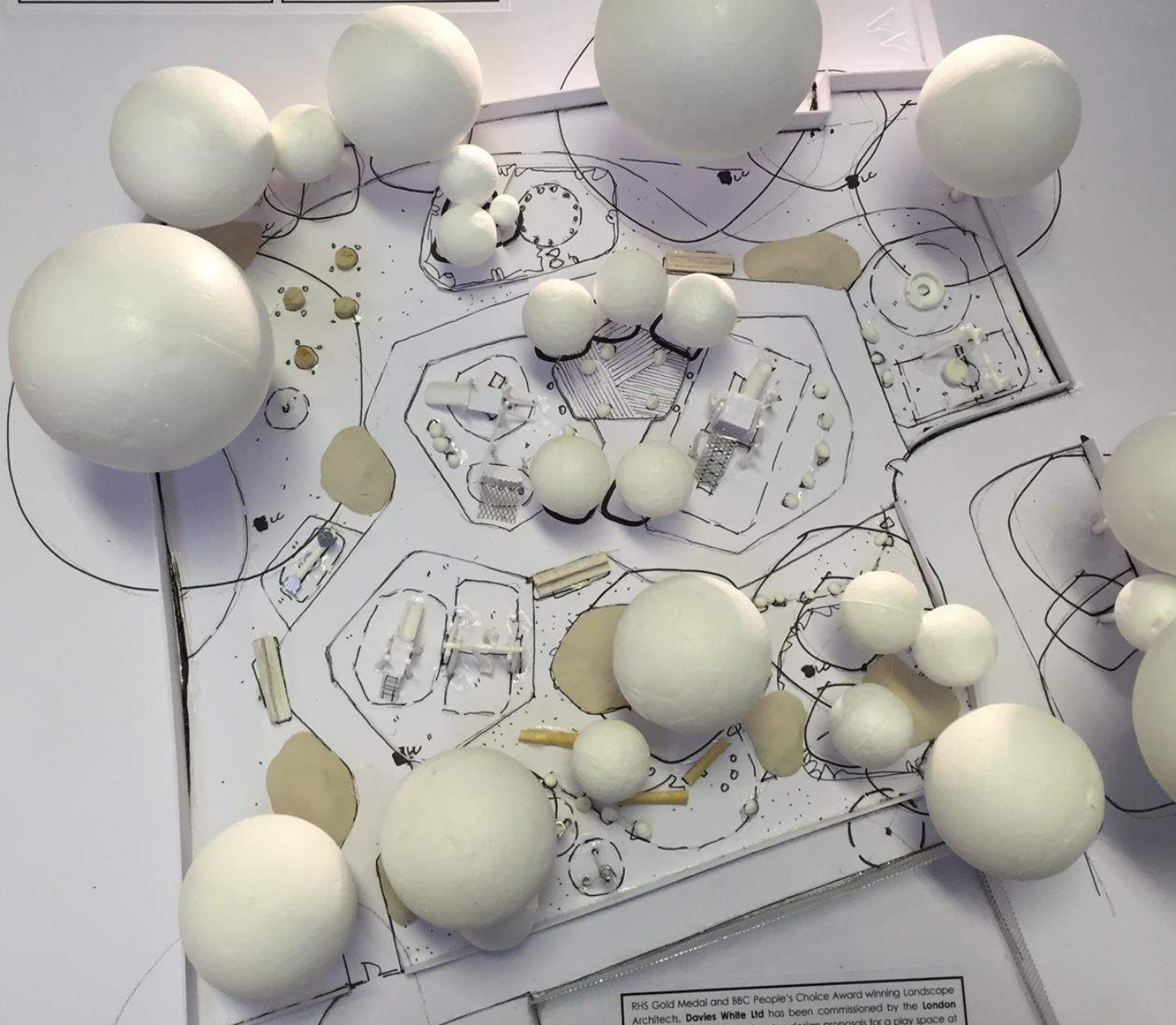

RHS Gold Medal and BBC People's Choice Award winning Landscape Architects, **Davies White Ltd** has been commissioned by the London Council to develop design proposals for a play space at Brunswick Park, London.



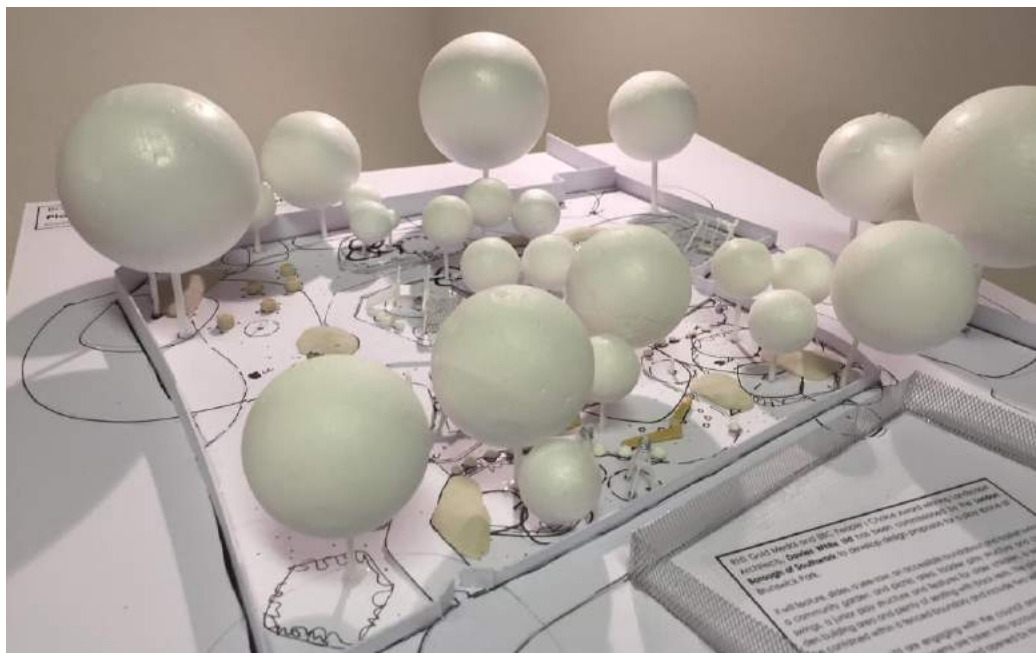
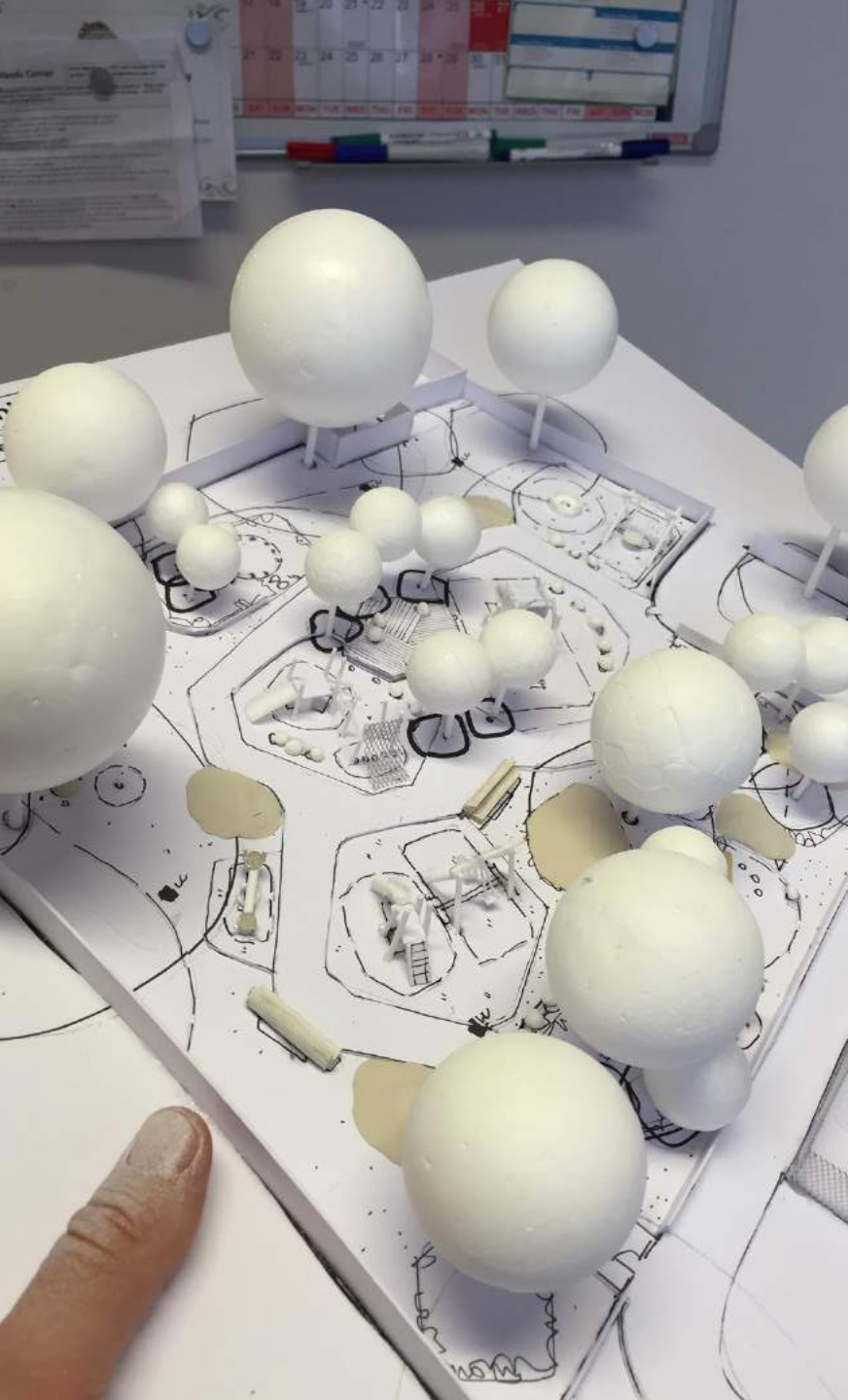



# Case Study Projects & Play Features

Basket Swing



**davieswhite**  
landscape architects  
davieswhite.co.uk



Round About





See Saw



Magnifying Posts



davieswhite  
landscape architects  
davieswhite.co.uk

Slides for all ages



Round-About



davieswhite  
landscape architects  
davieswhite.co.uk













King Georges Field Playscape, Hanwell, London Borough of Ealing

# Davies White Ltd

Chartered Landscape Architects

**Landscape  
Institute**  
Registered practice



British  
Association  
of Landscape  
Industries

51 Portland Road  
Kingston upon Thames  
Surrey KT1 2SH

[davies\\_white.co.uk](http://davies_white.co.uk)  
[@davies\\_white](https://www.instagram.com/davies_white)

**davieswhite**  
landscape architects  
[davieswhite.co.uk](http://davieswhite.co.uk)